

# Applying Instructions

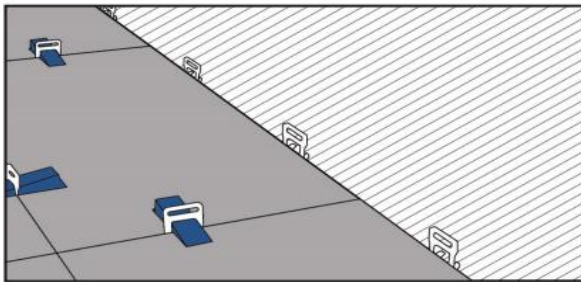

**1** - After applying the tile to the thinset, the clip should be placed on the side of the tile. Also, their flat sides should be the same as the base.

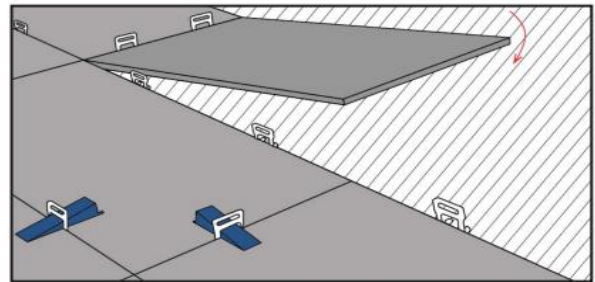

**2** - After placing the clip, place the next tile.  
 \* Depending on the size of the tile, it may be necessary to attach one or more clips on each side.  
 \* It is recommended to use clips every 20cm - 8" in on average.

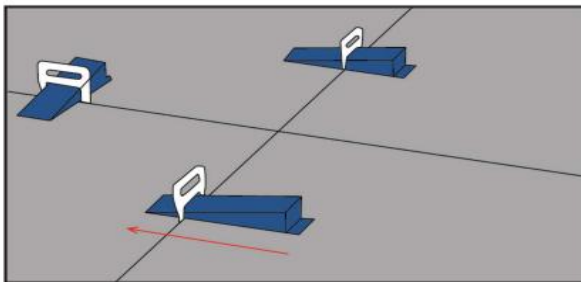

**3** - Wedges must be manually inserted into the clip. Wedges must be manually squeezed and attached to the clip socket.

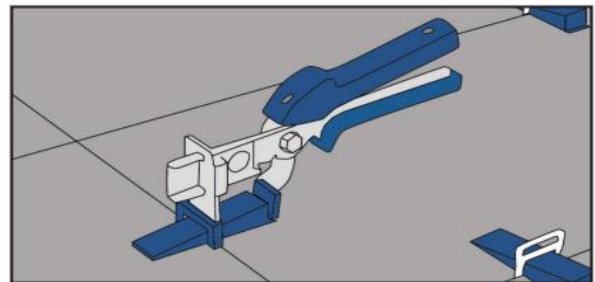

**4** - After squeezing the wedges together with adjustable pliers, the leveling process is complete.  
 \*Do not squeeze more than needed.

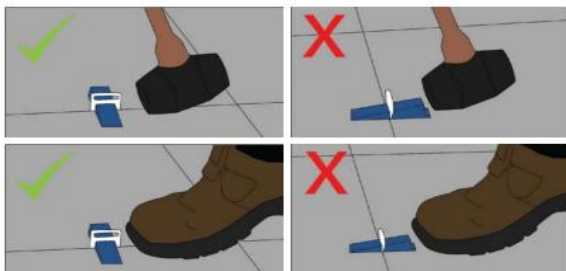

**6** - After attaching the clips and wedges to the tile, you need to wait 24 hours for the thinset to dry. It is advisable to increase the waiting time for long and oversized tiles. Therefore, it helps to minimize the deformation of the concave or convex surface of the tile.

**7** - When the thinset dries, remove the wedges and protruding parts of the clip from the surface of the tile. This operation can be done with a rubber mallet or a foot. To prevent damage to the tile cover, hit the clips from its sides. Clips are designed to break when hit from the side. Once the removal process is complete, the wedge will be recollected for future usage.

\*Do not hit the clips in the direction of compression.

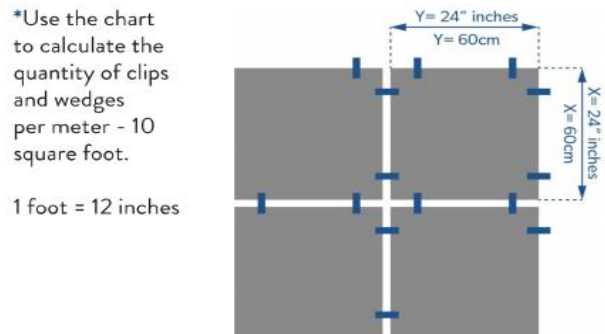

\*Use the chart to calculate the quantity of clips and wedges per meter - 10 square foot.

1 foot = 12 inches

		CM																		
		Y	15	20	25	30	33	40	50	60	75	90	100	120	150	180	200	240	300	CM
X			89	68	53	67	61	50	40	33	33	30	33	28	27	26	27	25	37	15
6	89		50	40	50	45	38	30	25	25	22	25	21	20	20	20	19	25	20	
8	68	50		32	40	36	30	24	20	20	18	20	17	16	16	16	15	19	25	
10	53	40	32		44	40	25	27	22	21	19	20	17	14	13	14	13	15	30	
12	67	50	40	44		37	31	24	20	19	17	18	15	15	14	14	13	13	33	
13	61	45	36	40	37		25	20	17	17	14	15	13	12	12	12	11	10	40	
16	50	38	30	25	31	25		16	13	12	11	12	10	10	9	9	9	9	50	
20	40	30	24	27	24	20	16		11	10	9	10	8	8	8	8	7	8	60	
24	33	25	20	22	20	17	13	11		9	8	9	7	8	7	7	7	7	75	
30	33	25	20	21	19	17	12	10	9		7	8	6	6	6	6	6	5	90	
36	30	22	18	19	17	14	11	9	8	7		8	7	6	6	6	5	5	100	
40	33	25	20	20	18	15	12	10	9	8	8		6	5	5	5	5	4	120	
48	28	21	17	17	15	13	10	8	7	6	7	6		5	5	4	4	4	150	
60	27	20	16	14	15	12	10	8	8	6	6	5	5		4	4	4	3	180	
70	26	20	16	13	14	12	9	8	7	6	6	5	5	4		4	4	3	200	
78	27	20	16	14	14	12	9	8	7	6	6	5	4	4	4		3	3	240	
96	25	19	15	13	13	11	9	7	7	6	5	5	4	4	4	3		3	300	
120	37	25	19	15	13	10	9	8	7	5	5	4	4	3	3	3	3			
IN		6	8	10	12	13	16	20	24	30	36	40	48	60	70	78	96	120	Y	
		INCHES																		